

Notes:

1. Refer to written specification and drawings listed therein.
2. Do not scale from this drawing. All dimensions to be checked on site. Do not make assumptions.

**Key**

- Natural Crown Green
- Synthetic Crown Green
- Ditch
- Path
- Indicative tree root protection zone
- Club House
- Toilet Block
- Irrigation Tank
- New Fence

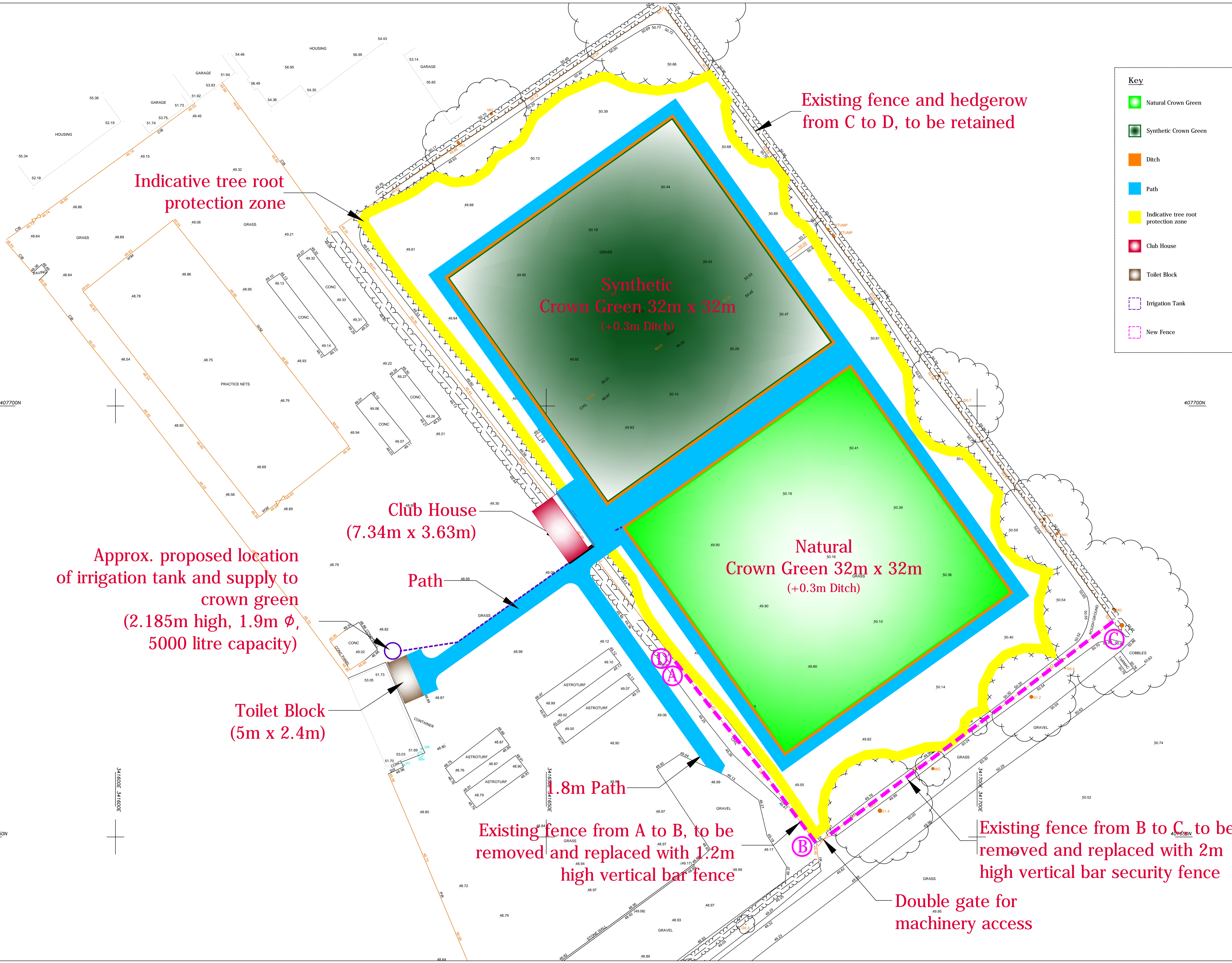

Existing fence and hedgerow from C to D, to be retained

Indicative tree root protection zone

Synthetic Crown Green 32m x 32m (+0.3m Ditch)

Natural Crown Green 32m x 32m (+0.3m Ditch)

Club House (7.34m x 3.63m)

Approx. proposed location of irrigation tank and supply to crown green (2.185m high, 1.9m  $\phi$ , 5000 litre capacity)

Toilet Block (5m x 2.4m)

Path

1.8m Path

Existing fence from A to B, to be removed and replaced with 1.2m high vertical bar fence

Existing fence from B to C, to be removed and replaced with 2m high vertical bar security fence

Double gate for machinery access

REVISIONS				
<p>Professional Sportsturf Design (North West) Ltd.                  42 Garstang Road, Preston, Lancs. PR1 1NA UK                  Tel: +44 (0)1772 884450 Fax: +44 (0) 1772 884445                  Email: consultants@psdagonomy.plus.com Website: www.psdagonomy.com</p>				
CLIENT	ORMSKIRK BOWLING CLUB			
PROJECT	TWO NEW CROWN GREEN BOWLING GREENS			
PROPOSED SITE PLAN				
Status	PRELIM	Issued by	NYB	Revision
Project No	2006	Date	DEC 2014	Drawing No
Paper Size	A1	Scale	1:200	2006/002